

THESE DRAWINGS AND SPECIFICATIONS ARE THE PROPERTY OF JBL INCORPORATED. THEY ARE ISSUED IN STRICT CONFIDENCE AND SHALL NOT BE REPRODUCED OR USED AS THE BASIS FOR MANUFACTURE OR APPARATUS WITHOUT WRITTEN PERMISSION.

ALL MATERIAL SPECIFIED ON THIS DRAWING SHALL CONTINUALLY COMPLY WITH THE EFFECTIVE EU ROHS DIRECTIVE, CURRENTLY 2011/65/EU, INCLUDING ALL AMENDMENTS.

REVISIONS			
LTR	DESCRIPTION	DFT	DATE
A	INITIAL RELEASE	VW	2/25/2025

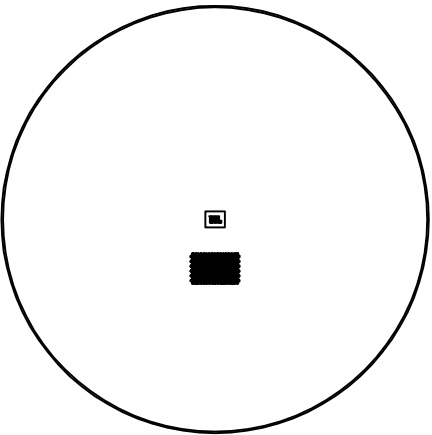
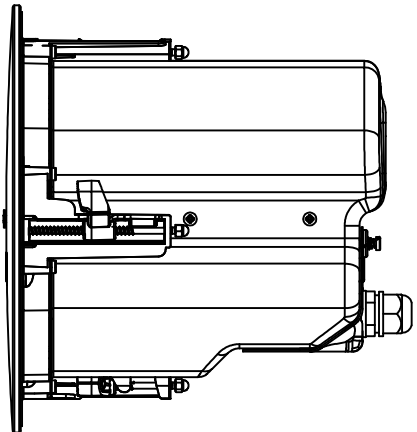
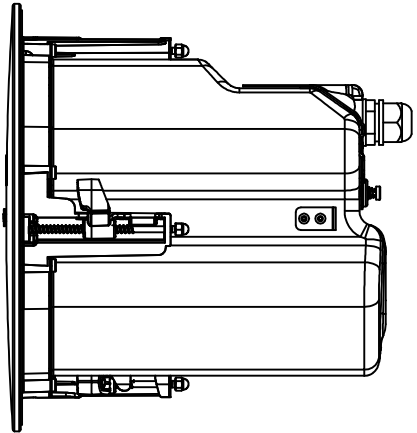
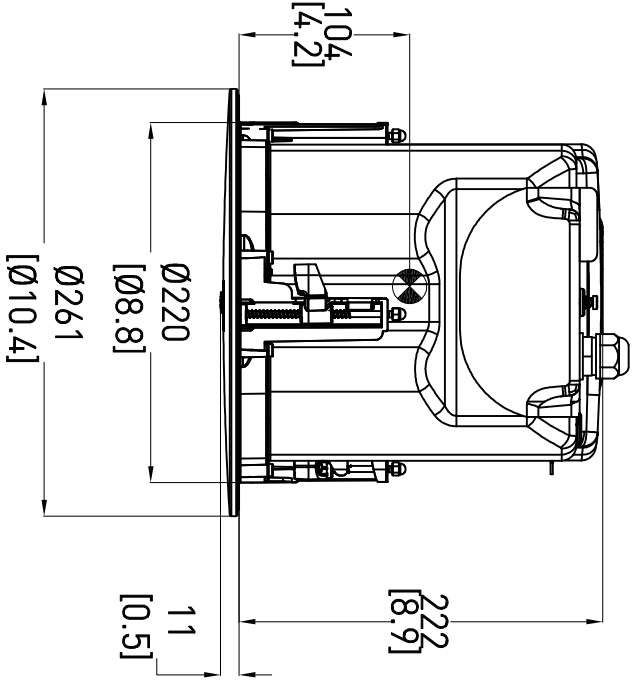
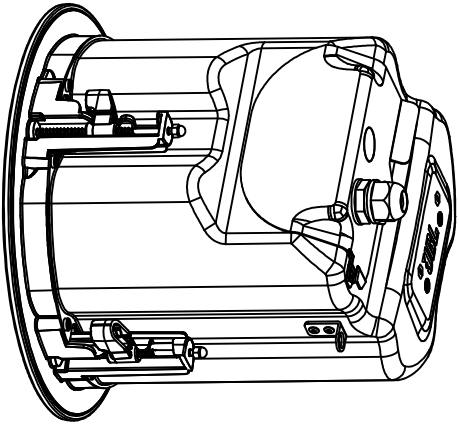
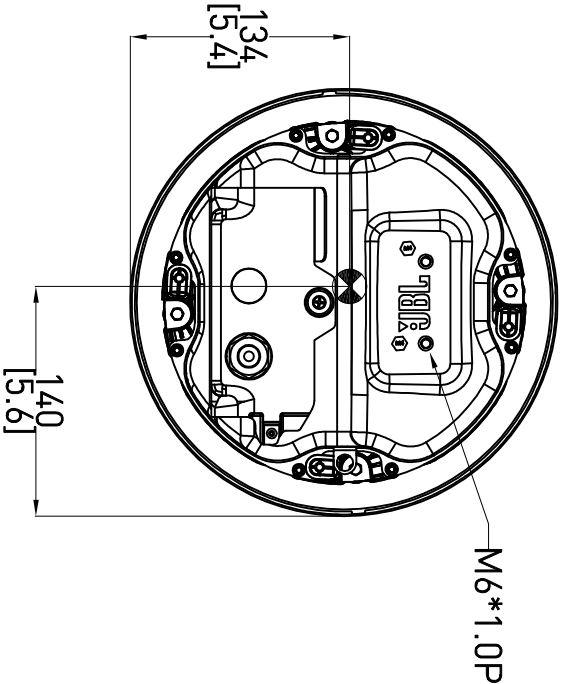

1. CABINET MATERIAL: Baffle: PC+ABS/Backcan: SPCE
2. FINISH: Baffle: Mold Texture+Backcan: Powder Coating.
3. WEIGHT: 3.68KG (7.94 LBS).
4. GRILLE MATERIAL: SPCC
5. SYMBOL INDICATES CENTER OF GRAVITY (CG).

NOTES: (UNLESS OTHERWISE SPECIFIED)

TOLERANCES (UNLESS OTHERWISE SPECIFIED)		HARMAN JBL Professional 8500 Balboa Blvd Northridge, CA 91329 USA	
X.XX ± .063 INCH			
X.X ± .125 INCH			
ANGULAR TOLERANCE OF 0°-30°			
FRACTIONAL DIMENSIONS ± 1/32		TITLE CUSTOMER DRAWING: C416 C-VA	
* DIMENSIONS ARE MM (INCHES)			
* ALL DIMENSIONS ARE FINISHED DIMENSIONS			
* DO NOT SCALE DRAWING			
SIZE	DRAWING NO.	REV	
A	1000382436	A	
SCALE	NTS	SHEET	OF
		1	1

A

B

C

D

A

B

C

D